

TOWNSHIP 3 S., RANGE 9 W.W.M. TILLAMOOK COUNTY ORE.

DATED FEB. 1974

To Pleasant Valley

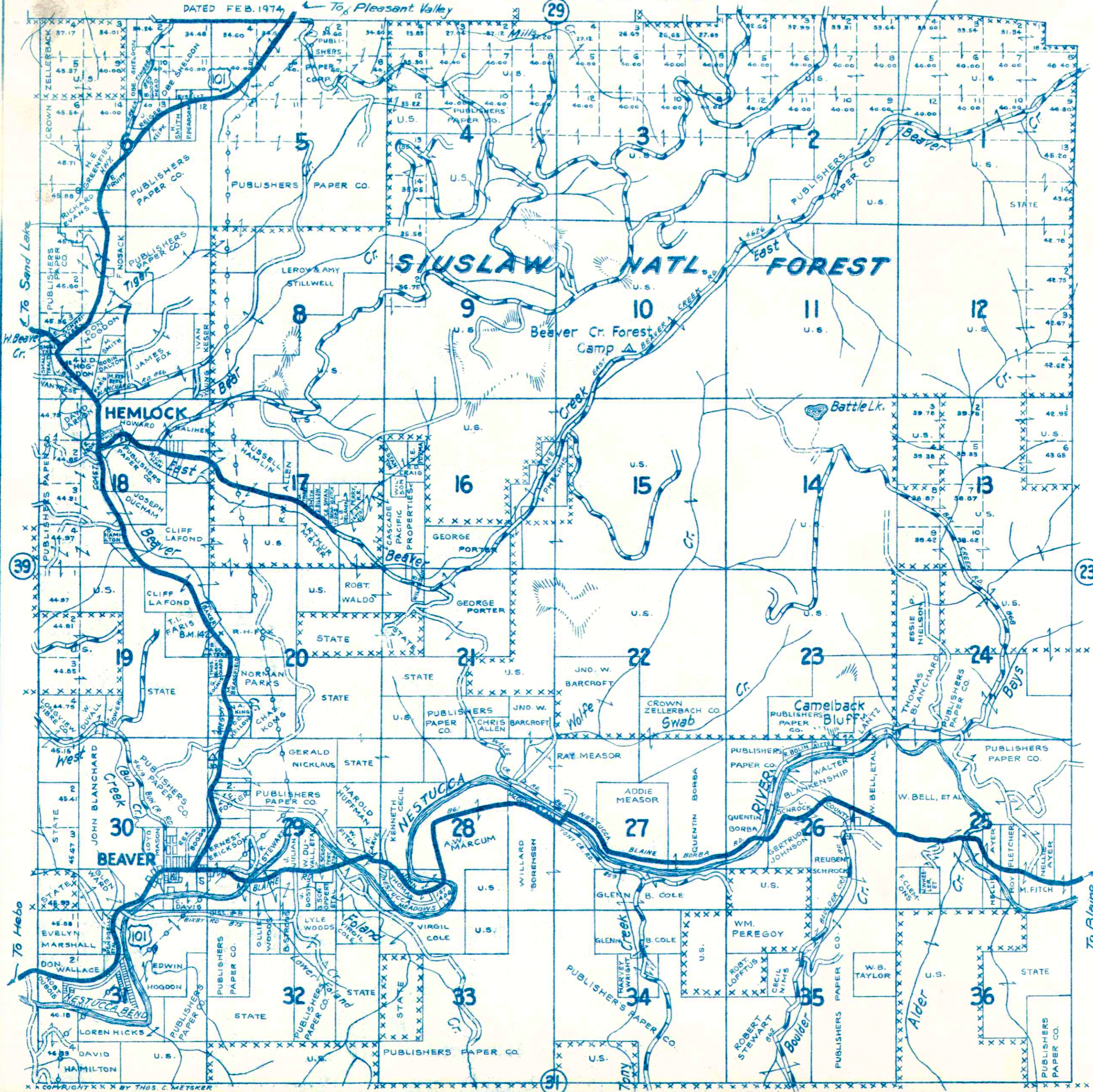

PLAT LIST
SEC. 30
A LA FONDS ADD TO BEAVER

Reproduction in whole
or part for personal use or
resale is prohibited by law.

LEGEND

- STATE HWY. ⑥ U.S. HWY. ⑩
- PAVED HIGHWAYS
- IMPROVED DIRT ROADS
- DIRT ROADS
- INFERIOR ROADS
- RAILROADS
- TRAILS
- INTERMITTENT CREEKS
- NAT'L. FOREST BDRY
- ELEC. PWR. TRANS. LINES